



**VIBRATOR FOR PLASTER
VIT
INSTRUCTION AND MAINTENANCE MANUAL**



DESCRIPTION

The size of this vibrator has been designed especially for use in the Dental Practice to cast the impression and to prepare the plaster molds.

The oscillating movement is originated by the attraction produced by an electromagnet on the metallic plate and as the consequent reaction of the mechanical shock absorbers.

Two different speed are available: the first providing a wider but less frequent oscillation, the second offering a lower but quicker oscillation.

INSTALLATION, USE AND MAINTENANCE

Put an insulation felt-cloth between the working bench and the vibrator in order to avoid any leakage in power. Connect the electrical plug to an earth 220 V - 50 Hz socket and choose the speed more suitable to the procedure to be carried out. We recommend to keep the model always well centered on the vibrator rubber cover.

<u>/!\ ATTENTION:</u>	The continuous use is allowed up to a maximum of 4 hours; after this period, it is advisable to let the vibrator rest and cool for at least one hour.
------------------------------	--

It is recommended to lift periodically the rubber cover and remove the plaster residuals which may stratify during the use.

<u>/!\ ATTENTION:</u>	Disconnect always the vibrator electrically before any maintenance operation inside the machine.
------------------------------	---

EXPLODED DRAWING AND SPARE-PART LIST FOR V I T (A0120)

NO.	CODE	DESCRIPTION
1	RVV004	RUBBER PLATE
2	RVV002	COVER
3	RVV010	ELECTROMAGNETIC GROUP
4	NEC011	CHANGE-OVER SWITCH
5	RVV003	VIBRATION-DAMPING BOTTOM
6	NEV010	ELECTRICAL CABLE WITH PLUG
7	NEA107	CABLE LOCKING RING
8	NEA180	DIODE
9	RVV001	BASE
10	RVV013	INSULATING CLOTH
11	RVV008	SPRING-GUIDE RING-NUT
12	RVV009	REACTION SPRING
13	RVV007	SPRING-GUIDE PIN
14	RVV005	IRON PLATE
15	NEA070	FUSE 5x20 / 3,15 A
16	NEA063	FUSE-HOLDER

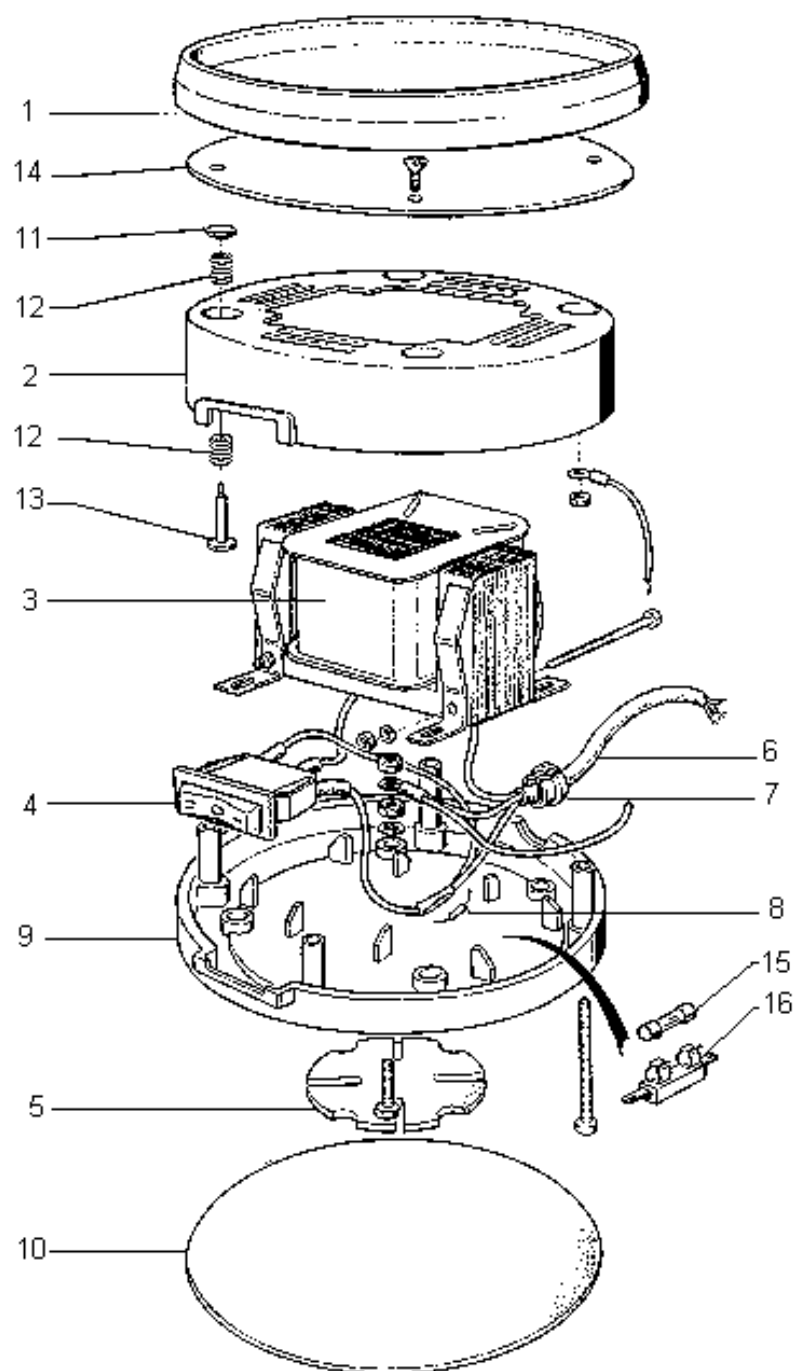

WIRING DIAGRAM

SYMBOL	DESCRIPTION
C	Change-over switch
IND	Inductance
1N4007	Diode
F1	Fuse 3,15A

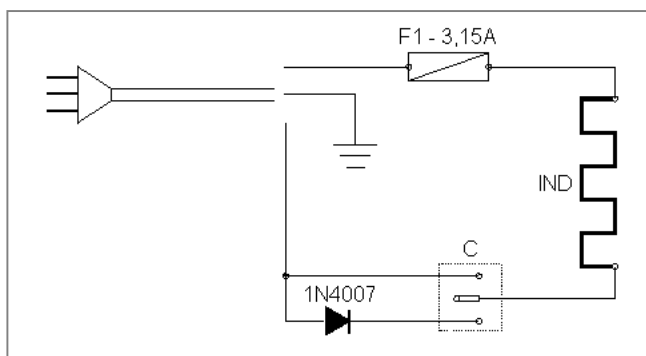

TECHNICAL FEATURES

Ø Cover mm	140
Height mm	120
Net weight Kg	1,8
Gross weight Kg	2,2
Working Tension	220 v - 50 Hz
Absorption	110W - 0,5A
Max permissible load Kg	2

TECHNICAL REFERENCE REGULATIONS AND TEST PROCEDURES

The vibrator mod. VIT is mass-manufactured by DENTALFARM in compliance with technical and safety rules in force, as provided for by the EEC 2006/42 Community Directive on Machinery.

Careful inspection and full routine testing is carried out singularly on each machine which is furtherly processed by an automatic testing installation assuring compliance with the fixed limits

DEMOLITION AND WASTE DISPOSAL

According to International regulations, this unit has been classified as AEE (electric and electronic device, whose correct operation depends on electric currents and electromagnetic fields) and as a consequence, at the end of its lifetime, it can not be treated as normal waste material but it must be disposed separately, complying with the Directive 2002/96/CEE.



DENTALFARM s.r.l.

Via Susa, 9/a - 10138 TORINO - ITALY

 TECHNICAL-COMMERCIAL SERVICE - (+39) 011/4346588

 AFTER-SALE ASSISTANCE - (+39) 011/4346632

 FAX 011/ 4346366 – Email: info@dentalfarm.it

Website: www.dentalfarm.it