

LMRondoPlus™

LM

feel the
difference



DESIGNED FOR EASE
LM-RondoPlus™ Sharpening Machine

SHARPNESS MATTERS

FOR OPTIMAL TREATMENT OUTCOMES

Regular maintenance of dental hand instruments is essential for ensuring safe, high-quality treatments.

Beyond cleanliness, the condition of an instrument significantly affects the treatment outcome and both your safety and your patient's well-being. When discussing hand instruments, the blade is a crucial factor—only sharp instruments guarantee optimal results.

ENHANCED SAFETY AND EFFICIENCY

Regular sharpening helps you work with a sharp instrument, reducing strain on your hand and enhancing safety throughout each treatment. Additionally, a well-maintained instrument has a longer service life than one that is neglected.

LM-RondoPlus™ is a simple and reliable sharpening machine suitable for all resharpenable hand instruments. It sharpens them effortlessly, quickly, and precisely.



LM-RondoPlus™

DESIGNED FOR EASE

EASY TO USE

Sharpening hand instruments is effortless with the right tools. The design of LM-RondoPlus™ takes into account various sharpening needs and individual techniques, ensuring a smooth sharpening process. It effectively sharpens both convex and straight cutting edges while maintaining the blade's original shape.

QUICK AND VERSATILE

LM-RondoPlus™ is always ready for use, allowing you to sharpen hand instruments efficiently in just seconds. No complex adjustments, instrument mounts, or grinding solutions are needed. Plus, the foot pedal enhances user comfort for an even more seamless experience.

SAFE AND ACCURATE

Operating at a low rotational speed, LM-RondoPlus™ sharpens instruments without overheating the blade or altering its steel properties. This ensures minimal wear, preserving the longevity and performance of your instruments.

- Compatible with all resharpenable hand instruments
- Simple, smooth, and precise sharpening
- Preserves original blade shape
- Minimizes metal wear
- Suitable for right- and left-handed users
- No grinding solutions needed
- Easy to clean and maintain
- Multiple sharpening stone options available



FEATURES

LM-RondoPlus™ is compatible with all hand instruments that can be resharpener. Thanks to its simple operation, learning to use the device takes only a few moments.

The ceramic sharpening stone is mounted in a 360° rotatable casing. The instrument is placed on the rest next to the stone —use the lower rest for periodontal instruments and the upper rest for preparation instruments. The hand holding the instrument remains still; sharpening is done by rotating the casing.

With LM-RondoPlus™, the same basic technique applies to all instrument types—whether periodontal or preparation instruments, and whether they have convex or straight cutting edges.

Scan the QR code for the LM-RondoPlus™ sharpening machine introduction video.

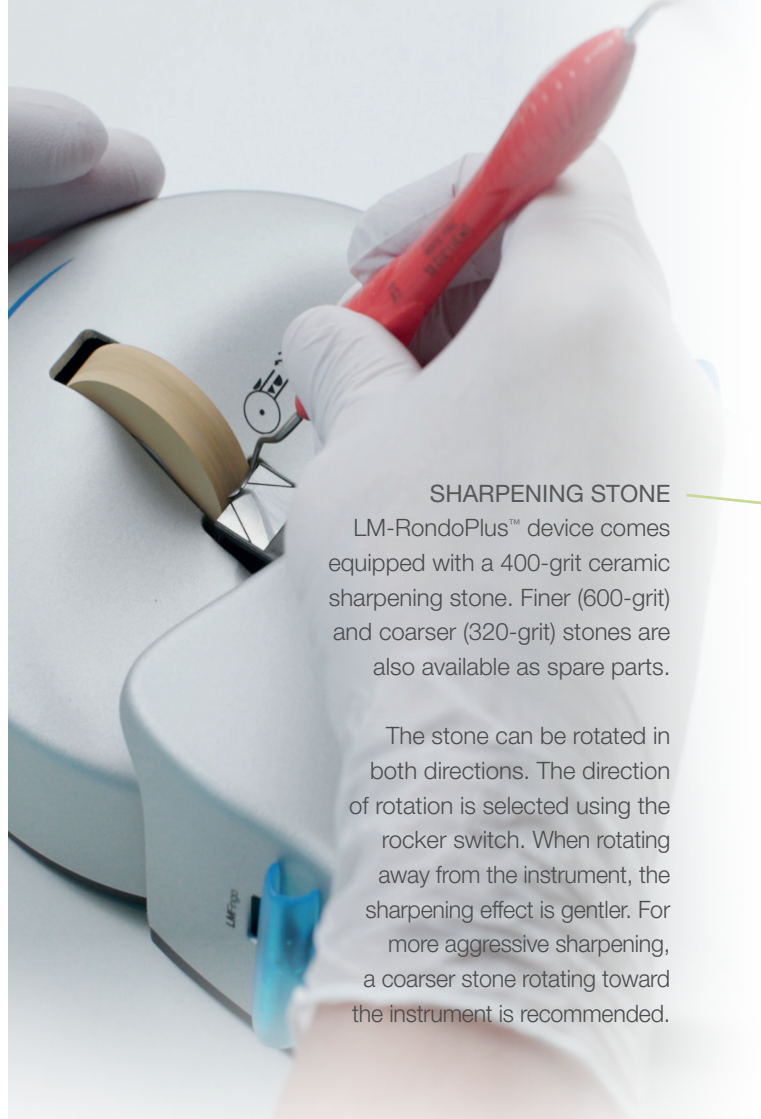

SHARPENING STONE

LM-RondoPlus™ device comes equipped with a 400-grit ceramic sharpening stone. Finer (600-grit) and coarser (320-grit) stones are also available as spare parts.

The stone can be rotated in both directions. The direction of rotation is selected using the rocker switch. When rotating away from the instrument, the sharpening effect is gentler. For more aggressive sharpening, a coarser stone rotating toward the instrument is recommended.

INSTRUMENT REST POSITIONS

The instrument rest has two positions: the lower position for periodontal instruments and the upper for preparation instruments. To change the position, gently lift the rest slightly away from the sharpening stone, then move it up or down.



FOOT PEDAL CONNECTION

Use of the foot pedal is optional. When connected, the sharpening stone rotates only while the pedal is pressed. The direction of rotation is still controlled by the rocker switch.

CASING
ROTATING
360°

HAND REST

ROCKER SWITCH /
DIRECTION CONTROL

INSTRUMENT REST ADJUSTMENT

The instrument rest should be positioned as close to the sharpening stone as possible without making contact. To adjust the distance, turn the control screw.



Scan the QR code for
the sharpness
testing video.



LM-FINGO™ TEST STICK

LM-RondoPlus™ comes with two LM-Fingo™ sticks for testing instrument sharpness. They can be used while mounted on the machine or worn on the finger. To test, lightly draw the instrument in its working position along the Fingo. A sharp instrument will bite into the stick; a dull one will glide, indicating the need for reshaping or replacement.

SHARPENING



Scan the QR code for videos demonstrating safe and effective sharpening methods for various instrument types.

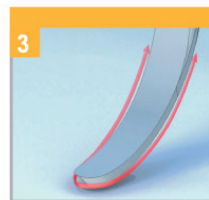
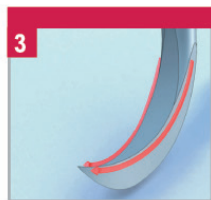
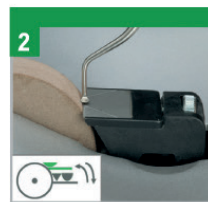
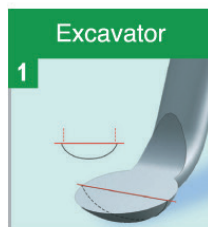
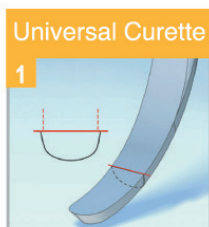
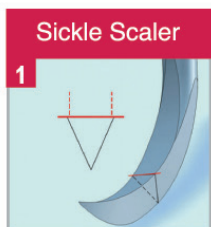

1 INSTRUMENT STRUCTURE

The sharpener does not need to worry about complex shank angles. The key focus should be on the instrument's lower shank and face, and ensuring they are positioned correctly during sharpening.

2 INSTRUMENT REST AND STARTING POSITION

Use the lower rest position for all periodontal instruments, the upper for all preparation instruments. Place the instrument on the rest with the face positioned horizontally.

3 SHARPENING

Hold the instrument steady and rotate the stone evenly along the cutting edge, following the red lines in the illustration. Continue until the cutting edge is sharp.

EASY MAINTENANCE

of Sharpening Stone

During sharpening, metal shavings from the instrument blade will loosen and stick to the surface of the sharpening stone. It is important to clean the stone after each sharpening session.

KEEPING THE STONE CLEAN

Maintaining the sharpening stone of the LM-RondoPlus™ is easy. While it is rotating, use a soft, lint-free cloth moistened with alcohol to remove any metal shavings from the surface.

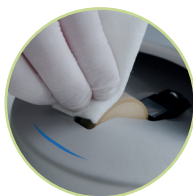

To maintain the stone's sharpening effectiveness, regular use of emery tapes is important.

CHANGING THE STONE

You can easily change the stone to a coarser or finer one, or replace it with a new one when needed.



Scan the QR code for sharpening stone maintenance video.



LM-RondoPlus™ 8600

Package includes the LM-RondoPlus™ sharpening machine with a 400-grit grinding stone, a foot pedal, two LM-Fingo™ test sticks, five emery tapes, and user guidance.

SPARE PARTS	PRODUCT CODE
Grinding stone, 600-grit, white (finer)	8660
Grinding stone, 400-grit, grey	8640
Grinding stone, 320-grit, black (courser)	8632
LM-Fingo™ 2 pcs	8602
LM-Fingo™ 6 pcs	8606
Foot pedal	8630
Emery tapes 5 pcs	8550

LMDental™



LM-Instruments Oy

Norrbyn rantatie 8 | FI-21600 Parainen | Finland

Tel. +358 2 4546 400

info@lm-dental.com | www.lm-dental.com

